

## Stationary Barcode Scanner

P200

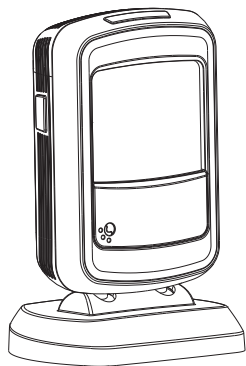

## Instruction Manual

### ■ Appearance

Front View (Unit: mm)

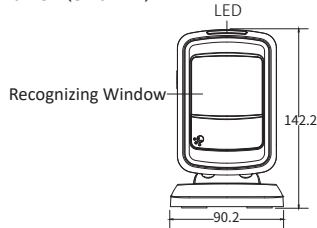

Rear View (Unit: mm)

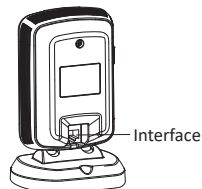

Left View (Unit: mm)

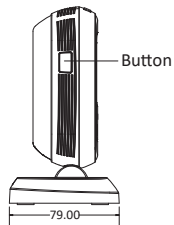

### ■ USB/RS232 Connection

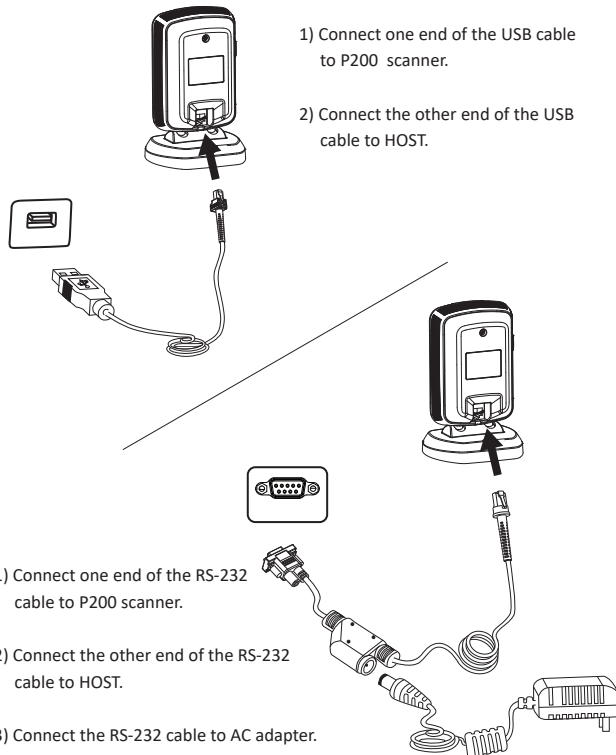

1) Connect one end of the USB cable to P200 scanner.

2) Connect the other end of the USB cable to HOST.

1) Connect one end of the RS-232 cable to P200 scanner.

2) Connect the other end of the RS-232 cable to HOST.

3) Connect the RS-232 cable to AC adapter.

### ■ Power on/off and Restart

► **Power on:** Can be used as soon as it is plugged in. And after the scanner is connected to the host, it automatically power on.

► **Power off:** Automatically power off after unplugging the cable.

► **Restart:** If the P200 scanner crashes or does not respond, please re-plug the cable.

### ■ Maintenance

- The recognizing window must be kept clean. Supplier is exempt from warranty liability for the damage caused by improper maintenance.
- Avoid hard and rough objects to scratch the recognizing window.
- Remove the stains from window with a brush.
- Please use a soft cloth to clean the window, such as glasses cloth.
- Do not spray any liquid on the window
- Do not use any cleaner other than cleaning water.

### ■ Buzzer

Status	Beeping times
Power on	3 times
Scan Successfully	1

### ■ Interface Setting

The scanner can communicate with the host by RS-232 serial port or USB port. The user can switch to the corresponding interface by replacing the data line and scanning the corresponding barcode below.

(1) RS232 Serial Port Barcode



(2) HID Virtual Keyboard



The scanner can be simulated into HID-KBW device when using the USB port. In this mode, the scanner will output data to the host as a virtual keyboard.

(3) USB Virtual Serial Port



When the scanner uses the USB port, but the host receives data by serial port, the scanner can be set to the USB virtual serial port (This feature requires the appropriate driver to be installed on the host).

### ■ Scanning Mode Setting

► Scan mode settings by scanning the barcode below

(1) Manual Mode

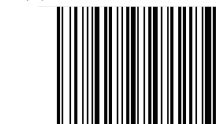

(2) Sensing Mode



## ■ Scanning Mode Setting

(3) continuous Mode

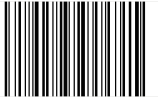

► Successfully recognize beep



## ■ Set Deafults

Scan the barcode to restore all scanner settings to the factory default state.



Note: Please use the “factory reset” function carefully. After reading this barcode, the current parameter settings will be lost and replaced with the factory default values.

## ■ Common Problem

Q: There are some barcodes can not be scan.

A: Firstly, check the barcode type, open the barcode function; if it is verified, try to turn off.

Q: The barcode data is incorrect.

A: Check the error display of barcodes (all barcodes errors or specific barcode error)

Q: Bar code can be read but not displayed.

A: Firstly, confirm the working mode of the scanner. If it is in RS-232 serial port mode, you need to connect with serial cable; if it is in USB virtual serial port mode, you need to connect with USB cable, and the host accepts with serial port tool. Both modes need to ensure that the serial port attribute of the serial port tool on the host is consistent with the serial port attribute of the device. If it is connected with a HID virtual keyboard, then directly connected by a USB cable.

Q: LED does not bright.

A:

- a) Check whether the device is powered on.
- b) Re-plug the data cable.

## ■ State

► Our company does not assume any responsibility for losses caused by natural disasters (such as earthquakes, floods, etc.) that exceed our scope of responsibility.

► In any case, our company does not assume any responsibility for losses caused by using this product, such as loss of profits, loss of reputation, business interruption, loss or change of stored data, and any special, unexpected, associated or intermittent losses caused by the above.

► Our company does not assume the responsibility for the losses caused by due to improper use of hardware or software not specified by the our company .

► Our company does not provide any form of warranty or technical support for the information, data, files, other products, services obtained though the use of this product, and does not assume any responsibility for the use of above description by users.

► Our company are not take any form of guarantee for third-party software used by this product.

► Due to the continuous improvement of the products, the operation and common problems of the models described in the manual are mainly based on actual machines. And it may be changed without notice.

## ■ FCC Warning

This device complies with part 15 of the FCC Rules.

Operation is subject to the following two conditions:

- (1) This device may not cause harmful interference, and
- (2) this device must accept any interference received, including interference that may cause undesired operation.

### NOTE:

This equipment has been tested and found to comply with the limits for a Class B digital device, pursuant to part 15 of the FCC Rules. These limits are designed to provide reasonable protection against harmful interference in a residential installation.

This equipment generates, uses and can radiate radio frequency energy and, if not installed and used in accordance with the instructions, may cause harmful interference to radio communications.

However, there is no guarantee that interference will not occur in a particular installation. If this equipment does cause harmful interference to radio or television reception, which can be determined by turning the equipment off and on, the user is encouraged to try to correct the interference by one or more of the following measures:

- Reorient or relocate the receiving antenna.
- Increase the separation between the equipment and receiver.
- Connect the equipment into an outlet on a circuit different from that to which the receiver is connected.
- Consult the dealer or an experienced radio/ TV technician for help.

## ■ FCC Warning

### Warning:

Changes or modifications to this unit not expressly approved by the part responsible for compliance could void the user’s authority to operate the equipment.

**Xiamen Hanin Electronic Technology Co.,Ltd.**

ADD:5F, 10# Building, Aide Airport Industrial Park, Huli District, Xiamen  
WEB:www.hpvt.com